

# FOR SUBLEASE

**\$15.84/NNN**

**195 Thomas Johnson Drive, Frederick, MD**

**MacRo**  
LTD.  
COMMERCIAL REAL ESTATE™



## Prime Space for Sublease in Professional Office Building

This 2,500-5,000 SF first floor office suite is situated within the Frederick Research Park medical corridor. This office suite features numerous private offices, private bathroom, lots of windows, and a private entryway. Excellent access to regional and local highways, including Route 15, Route 26, I-70, and I-270, and surrounded by convenient restaurants, retail, and medical facilities.

## PRESENTING

**Location:** 195 Thomas Johnson Drive, Frederick, Maryland

**Legal:** Tax Map 067B, Parcel 1132

**Zoning:** Frederick City: GC—The General Commercial district is intended to provide for a variety of retail use and services in free-standing parcels or shopping centers to serve the community's general commercial needs. This district shall only be applied at appropriate locations that conveniently meet these needs; conform to the goals, objectives and policies and locational criteria of the Comprehensive Plan; are compatible with the surrounding land uses and zoning districts; do not adversely impact the facilities and services of the City; do not set a precedent for the introduction of inappropriate uses into an area; and do not encourage non-residential strip development along streets.

**Property Details:**

- 2,500- 5,000 SF first floor office suites
- Surrounded by convenient restaurants, retail, and medical facilities
- Lots of windows
- Private bathroom
- Ample surface parking lot next to building

**Utilities:** Public water and sewer

**Contact:** Ashleigh Kiggans, Vice President  
Office: 301-698-9696 ext. 205  
Mobile: 703-507-1069  
Email: ashleigh@macroltd.com

Disclaimer: Information obtained from sources deemed to be reliable. However, we make no guarantee, warranty or representation. Information, prices, and other data may change without notice.

# LOCATION MAP

**MacRo**<sup>LTD.</sup>  
COMMERCIAL REAL ESTATE™

FOR LEASE 195 Thomas Johnson Drive, Frederick, MD



*Disclaimer: Information obtained from sources deemed to be reliable. However, we make no guarantee, warranty or representation. Information, prices, and other data may change without notice.*

# AERIAL

**MacRo**<sup>LTD.</sup>  
COMMERCIAL REAL ESTATE™

FOR LEASE 195 Thomas Johnson Drive, Frederick, MD



*Disclaimer: Information obtained from sources deemed to be reliable. However, we make no guarantee, warranty or representation. Information, prices, and other data may change without notice.*

# PHOTOS

**MacRo**<sup>LTD.</sup>  
COMMERCIAL REAL ESTATE™

FOR LEASE 195 Thomas Johnson Drive, Frederick, MD



*Disclaimer: Information obtained from sources deemed to be reliable. However, we make no guarantee, warranty or representation. Information, prices, and other data may change without notice.*

# FLOOR PLAN

FOR LEASE 195 Thomas Johnson Drive, Frederick, MD

**MacRo**<sup>LTD.</sup>  
COMMERCIAL REAL ESTATE™

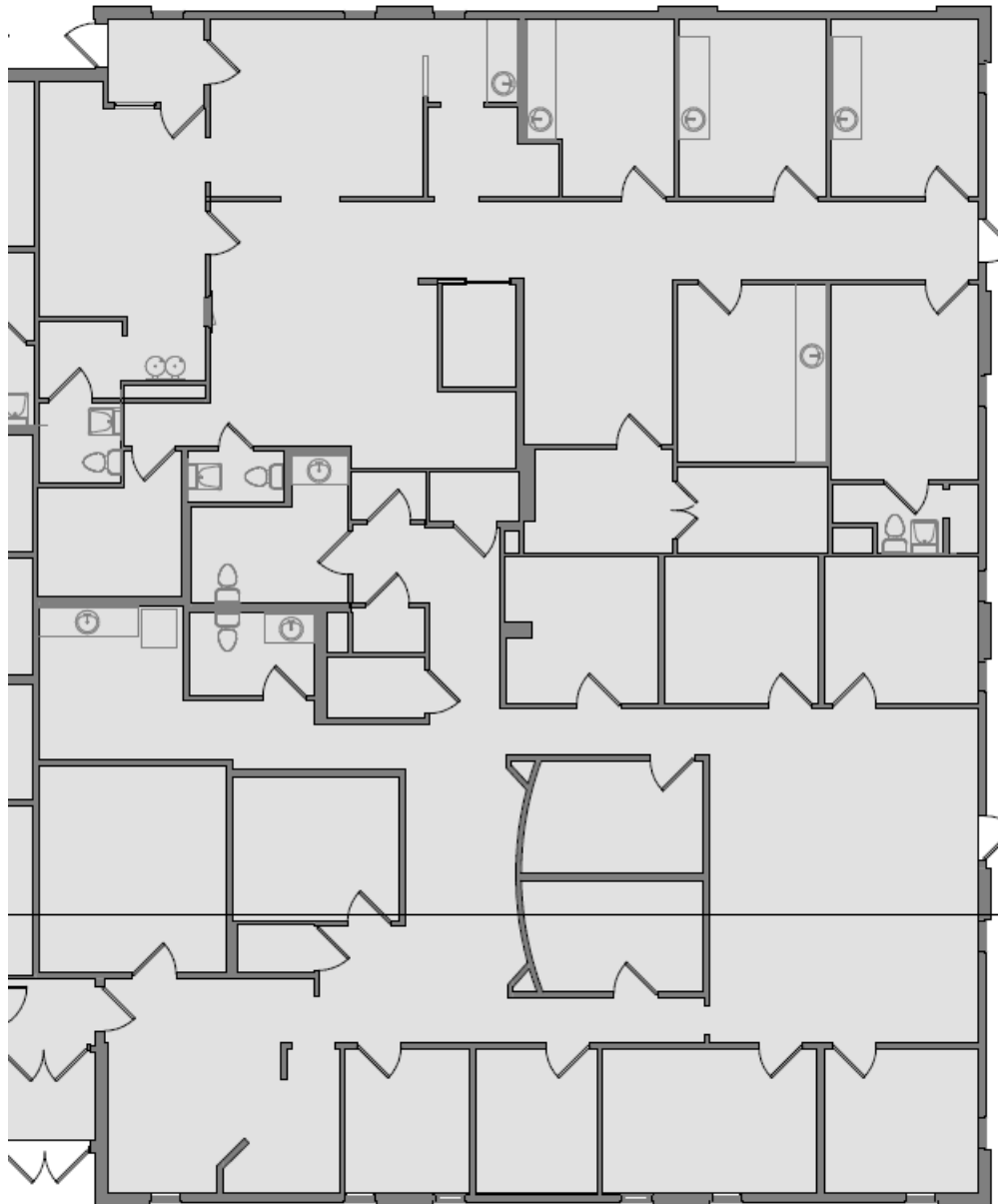

# ZONING

FOR SUBLEASE 195 Thomas Johnson Drive, Frederick MD

**MacRo**  
LTD.  
COMMERCIAL REAL ESTATE™

## Frederick City Zoning – GC (General Commercial)

The GC district is intended to provide for a variety of retail use and services in free-standing parcels or shopping centers to serve the community's general commercial needs. This district shall only be applied at appropriate locations that conveniently meet these needs; conform to the goals, objectives and policies and locational criteria of the Comprehensive Plan; are compatible with the surrounding land uses and zoning districts; do not adversely impact the facilities and services of the City; do not set a precedent for the introduction of inappropriate uses into an area; and do not encourage non-residential strip development along streets.

**Possible usage under zoning (permitted and some permitted use subject to site dev. plan approval) includes, but not limited to:**

- Accessory Apartments
- Hotel, Motel and Tourist Court
- Animal Care Services (including Grooming & Boarding)
- Animal Grooming (excluding Boarding)
- Antiques
- Apparel
- Arts, Crafts or Hobby Supplies
- Art Gallery (including Framing)
- Automobile Filling Station
- Automobile Parts or Accessories
- Automobile Sales & Services Center (Dealership)
- Automobile Sales Lot (New or Used)
- Bakery, Baked Goods Store
- Barber/ Cosmetology
- Bicycle (Non-Motorized) Sales and/or Repair
- Boats and Marine Supplies
- Books, Magazines, Newspapers, etc.
- Broadcasting, Recording Studio
- Building Supplies, Lumber
- Appliance Repair
- Carpenter, Cabinetmaker
- Electrician
- General Building Contractor (without Outdoor Storage Areas)
- Heating, Air-Conditioning, Refrigeration
- Locksmith
- Plumber
- Pipe Fitter, Construction Equipment Fabricator
- Roofer
- Sheet Metal Shop
- Sign Contractor
- Utility Contractor
- Window, Glass, Mirror
- Building Tradesmen Not Otherwise Listed
- Business Machines / Business Service Centers
- Camera Sales & Photo Processing (including Development & Printing Services)
- Carwash
- Cards, Stationary
- Caterer
- Commercial Use in Historic Buildings
- Construction Equipment: Sales, Service and Rental
- Convenience Stores, with or without Gas Sales
- Dance, Music Instruction
- Delicatessen
- Department Store
- Discount Store
- Drugs and Cosmetics
- Dry Cleaning
- Electrical Systems Service
- Eyeglasses, Hearing Aids
- Fabrics, Sewing Supplies & Machines
- Farm Machinery Rental, Sales & Service
- Farm Supplies & Hardware (including Landscape and Garden Sales)
- Farmers Markets
- Financial Services (Bank, Savings and Loan, Credit Union Office)
- Floor Covering
- Flowers (Florist Shop)
- Furniture and/or Appliances
- Garden Center (including Sales of Trees, Shrubs, Garden Supplies)
- Gun Sales
- Grocery Stores
- Handicraft Items (such as Pottery, Stained Glass, Woodwork)
- Hardware, Inside Storage
- Ice Cream Parlor
- Industrial Equipment, Plumbing Supplies and Other Heavy Consumer Goods not Listed, Sales & Service, with Outdoor Storage
- Interior Decorator
- Jewelry
- Laundromat
- Lighting, Electrical Supplies
- Continued Next Page

*Disclaimer: Information obtained from sources deemed to be reliable. However, we make no guarantee, warranty or representation. Information, prices, and other data may change without notice.*

# ZONING (Continued)



FOR SUBLEASE 195 Thomas Johnson Drive, Frederick MD

- Lighting, Electrical Supplies
- Liquor, Beer, Wine
- Luggage, Leather Goods
- Meats, Butcher Shop
- Medical Supplies
- Mobil Homes, Trailers, Recreational Vehicles
- Motorcycles, ATV's, Sales and Repair
- Music & Records, Sales and Repair
- Musical Instruments
- Novelties, Souvenirs, Gifts
- Office Furniture
- Office Supplies
- Offices, Business & Professional
- Offices, Regional (Bank, Savings and Loan, Credit Union, Insurance)
- Paint, Wallpaper
- Personal Services (e.g., Nail Salons, Barbers, Shoe Repair, etc.)
- Pet Store or Pet Supply Store
- Photography Studio
- Picture Framing
- Professional Service Not Otherwise Listed
- Radio, TV Sales and Repair
- Restaurant, General and/or Fast Food
- Restaurant with Entertainment
- Retail Sales not Otherwise Listed
- Shoes
- Shopping Center
- Sporting Goods
- Stone Monuments (with or without Engraving)
- Tailoring
- Tires, Batteries, Mufflers
- Tobacco Products
- Toys
- Truck Sales & Rental (over 1 Ton)
- Truck Wash
- Upholstery, Curtain, Drapery Service
- Used Merchandise Auction
- Vehicle Services, Auto Repair Shop
- Vehicle Services, Truck (over 1 Ton) Service and Repair Shop
- Veterinary Clinic/Hospital without Boarding
- Veterinary Clinic with Boarding
- Video/DVD (Sales or Rental)
- Warehouse Clubs and Superstores
- Appliances, Assembly Production
- Construction Equipment, Assembly Production
- Electronic Components, Manufacturing and Processing
- Electronic Equipment, Assembly Production
- Janitorial Services
- Medical Laboratory
- Newspaper Printing
- Laboratory & Testing Offices in Conjunction with Scientific or Industrial Research and Development
- Printing, Bulk Photo Processing, Blueprinting Services
- Moving and Storage Facility
- Self Storage
- Storage Warehouse
- Trucking Offices & Storage, Repair Shop
- Adult Bookstore and/or Adult Entertainment Centers
- Arcade (Pinball, Video)
- Bowling
- Conference Center
- Fine Arts Studio
- Golf Course and Club / Driving Range
- Health Club or Spa
- Indoor Sports Complex
- Miniature Golf
- Park
- Pool, Billiards
- Private Club
- Reception Facility
- Skating Rink
- Swimming Pools (Non-Accessory)
- Tennis, Racquet Sports
- Theater, Movie / Stage
- Adult Day Care Center
- Child Day Care Center
- Church
- Funeral Home (with or without Crematorium)
- Sheltered Workshop
- Vo-Tech, Trade Schools & Training Centers
- Parking Lot, Parking Garage, Private
- Truck Stop
- Communication Antenna on Existing City-Owned Water Towers, High Voltage Electric Transmission Towers and Existing Athletic Lighting Structures, over sixty 60 Feet in Height, on Public Land
- Communication Towers and Antennas
- Telecommunication Antennas Enclosed within an Existing Structure or Building Subject to Section 27-779
- Agricultural Production
- Greenhouse, Commercial
- And more...

*Disclaimer: Information obtained from sources deemed to be reliable. However, we make no guarantee, warranty or representation. Information, prices, and other data may change without notice.*